



CARSA V2LED



CARSA V2LED

CARSA V2LED 12W-NW-SN

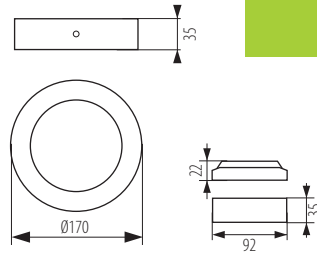

CARSA V2LED 18W-NW-SN

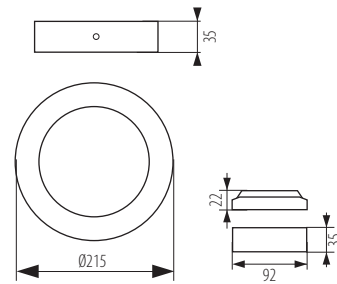

220-240V~
50/60Hz

T_c (K)
4000

[lm]
110



2 x 0,75mm²
5 cm

≥20000

[h]
15000

IP
20



EAC

CE

Kanlux



[W]



[lm]

CARSA V2LED 12W-NW-SN	27210	12	720
CARSA V2LED 18W-NW-SN	27211	18	1200



DE

weiß / satinnickel
Gehäuse: Aluminiumlegierung / Glocke: Kunststoff

Netzgerät im Lieferumfang enthalten

EN

white / satin nickel
casing: aluminium alloy / diffuser: plastic

power supply unit included

FR

blanc / nickel satiné
boîtier: alliage d'aluminium / vasque: plastique

adaptateur inclus