

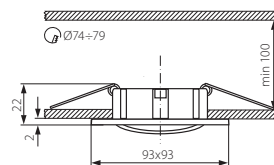

PELIA CT-DTL50-AB



PELIA CT-DTL50-C/M



- ▶ casing: aluminum alloy cast
- ▶ Gehäuse: Aluminium Druckguss

PELIA CT-DTL50-AB	19540	antic brass / messing patiniert	
PELIA CT-DTL50-C/M	19541	matt chrome / mattchrom	

12V	max 50	MR-16	Gx5,3	30°	2 x 0,75mm ² 15 cm	0,5	IP 20	House icon	III	1/-/50	146 [g]	CE
-----	--------	-------	-------	-----	----------------------------------	-----	-------	------------	-----	--------	---------	----

SIMI CT



SIMI CT-DTO50-AB



SIMI CT-DTO50-C/M

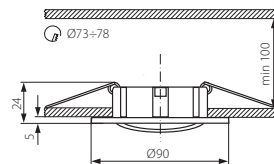

- ▶ casing: aluminum alloy cast
- ▶ Gehäuse: Aluminium Druckguss

SIMI CT-DTO50-AB	19500	antic brass / messing patiniert	
SIMI CT-DTO50-C/M	19501	matt chrome / mattchrom	

12V	max 50	MR-16	Gx5,3	30°	2 x 0,75mm ² 15 cm	0,5	IP 20	House icon	III	1/-/50	104 [g]	CE
-----	--------	-------	-------	-----	----------------------------------	-----	-------	------------	-----	--------	---------	----