

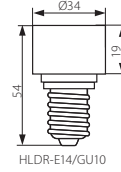

HLDR-E14/GU10

HLDR-E27/GU10



HLDR-E14/GU10

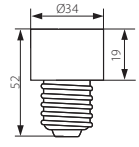

HLDR-E27/GU10

▶ body: plastic/ceramics

▶ Grundkörper: Kunststoff/Keramik

Kanlux				
HLDR-E14/GU10	08851	E14/GU10	white / weiß	26
HLDR-E27/GU10	08850	E27/GU10	white / weiß	28

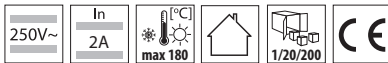

maximum permissible socket temperature 180°C / maximale permissible power of the light source is 35W
die maximal zulässige Fassungstemperatur beträgt 180°C / die maximal zulässige Leistung der Lichtquelle beträgt 35W

Ceramic socket / Keramik-Lampenfassung

HLDR



HLDR-E14



HLDR-E14-F

HLDR-E27

HLDR-E27-F

HLDR-E27-D

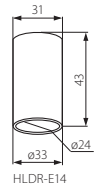

HLDR-E14

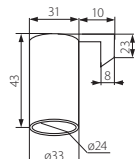

HLDR-E14-F

▶ body: ceramics

▶ Grundkörper: Keramik

Kanlux					
HLDR-E14	02170	grey / grau	2A	E14	50
HLDR-E14-F	02173	grey / grau	2A	E14	55
HLDR-E27	02160	grey / grau	4A	E27	52
HLDR-E27-F	02161	grey / grau	4A	E27	58
HLDR-E27-D	02162	grey / grau	4A	E27	56

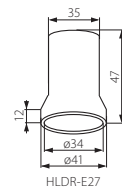

HLDR-E27

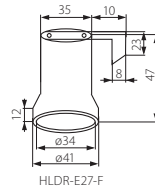

HLDR-E27-F

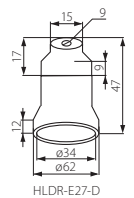

HLDR-E27-D

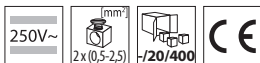

maximum permissible socket temperature 180°C / die maximal zulässige Fassungstemperatur beträgt 180°C