

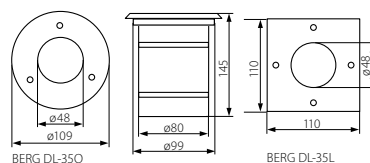

BERG DL-350



BERG DL-35L



BERG DL-350

BERG DL-35L

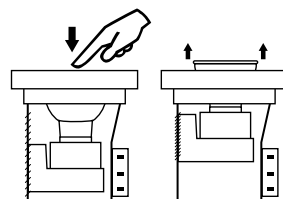

curve of intensity distribution /  
Lichtverteilungskurve

$\eta = 64\%$

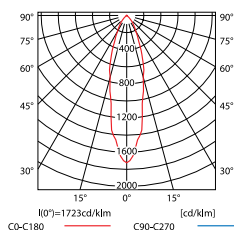

$I(\theta^\circ) = 1723 \text{cd/klm}$  C90-C270 C0-C180

- ▶ casing: steel sheet / front panel: stainless steel / protective pane: tempered glass
- ▶ Gehäuse: Aluminium Druckguss / Frontpaneel: Edelstahl / Schutzscheibe: stossfestes Schutzglas

Kanlux			[g]
BERG DL-350	07170	stainless steel / Edelstahl	750
BERG DL-35L	07171	stainless steel / Edelstahl	820

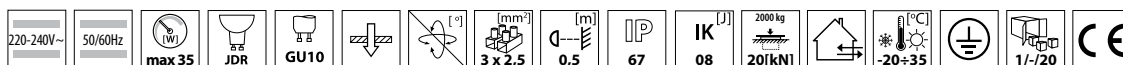

mounting box included / possibility of pass-through supply / easy light source exchange / Maximum luminaire-protection glass temperature  $T_{max} = 160^\circ\text{C}$  (Halogen 35W) / The luminaire may only be installed in areas which are inaccessible to the touch (in accordance with the installation instructions).

inklusive Montagedose / Durchgangsverbinding der Leuchten möglich / erleichterter Austausch der Lichtquellen / Maximale Leuchtenschutzglastemperatur  $T_{max} = 160^\circ\text{C}$  (Halogen 35W) / Die Leuchte darf nur in Bereichen installiert werden, die sich außer Reichweite befinden (gemäß den Installationsvorschriften).