

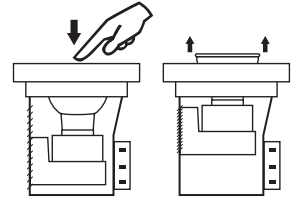

BERG DL-350

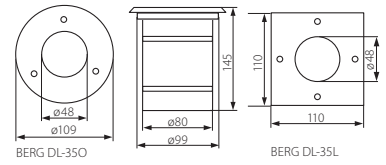

BERG DL-35L



curve of intensity distribution /
Lichtverteilungskurve
 $\eta = 64\%$

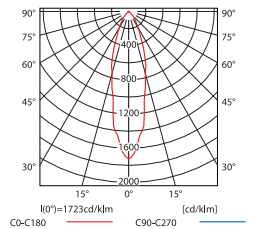

- ▶ casing: steel sheet / front panel: stainless steel / protective pane: tempered glass
- ▶ Gehäuse: Aluminium Druckguss / Frontpaneel: Edelstahl / Schutzscheibe: stossfestes Schutzglas

Kanlux			
BERG DL-350	07170	stainless steel / Edelstahl	750
BERG DL-35L	07171	stainless steel / Edelstahl	820

mounting box included / possibility of pass-through supply / easy light source exchange
inklusive Montagdose / Durchgangsverbinding der Leuchten möglich / erleichterter Austausch der Lichtquellen